

FULLY THREADED
STUDBOLTS
ANSI B16.5

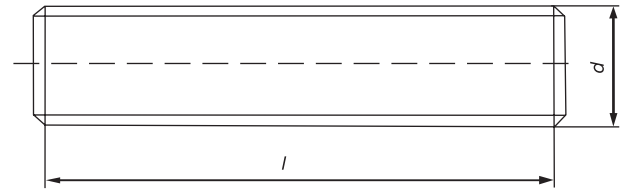

SALES DEPT.: TEL. ++39 02 96.97.98.20
PURCHASE DEPT.: TEL. ++39 02 96.97.98.30
EXPEDITING DEPT.: TEL. ++39 02 96.97.98.40

VIA DELL'ARTIGIANATO 12 - 22078 TURATE (CO) - ITALY
TEL. ++39 02 96.97.98.01 - FAX ++39 02 96.97.98.29
E-MAIL: info@pressbolt.com - WEB SITE: www.pressbolt.com

PRESS BOLT
S.R.L.

d \ l		WEIGHT (Kg) PER 1 PIECE (IMPERIAL SIZE)													
		3/8"	7/16"	1/2"	9/16"	5/8"	3/4"	7/8"	1"	1.1/8"	1.1/4"	1.3/8"	1.1/2"	1.5/8"	1.3/4"
50	2"	0.024	0.032	0.044	0.055	0.070	0.103	0.141	0.185	0.238	0.299	0.366	0.441	0.521	0.611
55	2.1/4"	0.026	0.035	0.048	0.060	0.076	0.112	0.154	0.202	0.260	0.326	0.399	0.481	0.569	0.666
60	2.3/8"	0.028	0.038	0.052	0.065	0.083	0.122	0.166	0.218	0.281	0.353	0.432	0.521	0.616	0.722
65	2.1/2"	0.030	0.041	0.056	0.070	0.089	0.131	0.179	0.235	0.303	0.380	0.466	0.561	0.664	0.777
70	2.3/4"	0.032	0.044	0.060	0.075	0.095	0.140	0.192	0.252	0.325	0.407	0.499	0.601	0.711	0.833
75	3"	0.034	0.047	0.064	0.080	0.102	0.150	0.205	0.269	0.346	0.434	0.532	0.641	0.758	0.888
80	3.1/8"	0.037	0.050	0.068	0.085	0.108	0.159	0.218	0.286	0.368	0.462	0.565	0.681	0.806	0.944
85	3.1/4"	0.039	0.053	0.072	0.090	0.114	0.168	0.230	0.302	0.390	0.489	0.599	0.721	0.853	0.999
90	3.1/2"	0.041	0.056	0.076	0.095	0.121	0.178	0.243	0.319	0.411	0.516	0.632	0.761	0.901	1.055
95	3.3/4"	0.043	0.059	0.081	0.100	0.127	0.187	0.256	0.336	0.433	0.543	0.665	0.801	0.948	1.110
100	4"	0.045	0.061	0.085	0.105	0.133	0.196	0.269	0.353	0.455	0.570	0.698	0.841	0.995	1.166
105	4.1/8"	0.047	0.064	0.089	0.110	0.140	0.206	0.282	0.370	0.476	0.597	0.732	0.881	1.043	1.221
110	4.1/4"	0.050	0.067	0.093	0.115	0.146	0.215	0.294	0.386	0.498	0.624	0.765	0.921	1.090	1.277
115	4.1/2"	0.052	0.070	0.097	0.120	0.152	0.224	0.307	0.403	0.520	0.652	0.798	0.961	1.138	1.332
120	4.3/4"	0.054	0.073	0.101	0.125	0.159	0.234	0.320	0.420	0.541	0.679	0.831	1.001	1.185	1.388
125	5"	0.056	0.076	0.105	0.130	0.165	0.243	0.333	0.437	0.563	0.706	0.865	1.041	1.232	1.443
130	5.1/8"	0.058	0.079	0.109	0.135	0.171	0.252	0.346	0.454	0.585	0.733	0.898	1.081	1.280	1.499
135	5.1/4"	0.060	0.082	0.113	0.140	0.178	0.262	0.358	0.470	0.606	0.760	0.931	1.121	1.327	1.554
140	5.1/2"	0.062	0.085	0.117	0.145	0.184	0.271	0.371	0.487	0.628	0.787	0.964	1.161	1.375	1.610
145	5.3/4"	0.065	0.088	0.121	0.150	0.191	0.281	0.384	0.504	0.650	0.815	0.998	1.202	1.422	1.665
150	6"	0.067	0.091	0.125	0.155	0.197	0.290	0.397	0.521	0.671	0.842	1.031	1.242	1.469	1.721
155	6.1/8"	0.069	0.094	0.129	0.159	0.203	0.299	0.410	0.538	0.693	0.869	1.064	1.282	1.517	1.776
160	6.1/4"	0.071	0.097	0.133	0.164	0.210	0.309	0.422	0.554	0.714	0.896	1.097	1.322	1.564	1.832
165	6.1/2"	0.073	0.100	0.137	0.169	0.216	0.318	0.435	0.571	0.736	0.923	1.131	1.362	1.612	1.887
170	6.3/4"	0.075	0.102	0.141	0.174	0.222	0.327	0.448	0.588	0.758	0.950	1.164	1.402	1.659	1.943
175	6.7/8"	0.078	0.105	0.145	0.179	0.229	0.337	0.461	0.605	0.779	0.977	1.197	1.442	1.706	1.998
180	7"	0.080	0.108	0.149	0.184	0.235	0.346	0.474	0.622	0.801	1.005	1.230	1.482	1.754	2.054
185	7.1/4"	0.082	0.111	0.153	0.189	0.241	0.355	0.486	0.638	0.823	1.032	1.264	1.522	1.801	2.109
190	7.1/2"	0.084	0.114	0.157	0.194	0.248	0.365	0.499	0.655	0.844	1.059	1.297	1.562	1.849	2.165
195	7.3/4"	0.086	0.117	0.161	0.199	0.254	0.374	0.512	0.672	0.866	1.086	1.330	1.602	1.896	2.220
200	7.7/8"	0.088	0.120	0.165	0.204	0.260	0.383	0.525	0.689	0.888	1.113	1.363	1.642	1.943	2.276
205	8"	0.091	0.123	0.169	0.209	0.267	0.393	0.538	0.706	0.909	1.140	1.397	1.682	1.991	2.331
210	8.1/4"	0.093	0.126	0.173	0.214	0.273	0.402	0.550	0.722	0.931	1.167	1.430	1.722	2.038	2.387
215	8.1/2"	0.095	0.129	0.177	0.219	0.279	0.411	0.563	0.739	0.953	1.195	1.463	1.762	2.086	2.442
220	8.3/4"	0.097	0.132	0.181	0.224	0.286	0.421	0.576	0.756	0.974	1.222	1.496	1.802	2.133	2.498
225	8.7/8"	0.099	0.135	0.185	0.229	0.292	0.430	0.589	0.773	0.996	1.249	1.530	1.842	2.180	2.553
230	9"	0.101	0.138	0.189	0.234	0.298	0.439	0.602	0.790	1.018	1.276	1.563	1.882	2.228	2.609
235	9.1/4"	0.103	0.141	0.193	0.239	0.305	0.449	0.614	0.806	1.039	1.303	1.596	1.922	2.275	2.664
240	9.1/2"	0.106	0.143	0.197	0.244	0.311	0.458	0.627	0.823	1.061	1.330	1.629	1.962	2.323	2.720
245	9.5/8"	0.108	0.146	0.201	0.249	0.318	0.468	0.640	0.840	1.083	1.358	1.663	2.003	2.370	2.775
250	9.3/4"	0.110	0.149	0.205	0.254	0.324	0.477	0.653	0.857	1.104	1.385	1.696	2.043	2.417	2.831
255	10"	0.112	0.152	0.209	0.259	0.330	0.486	0.666	0.874	1.126	1.412	1.729	2.083	2.465	2.886
260	10.1/4"	0.114	0.155	0.213	0.264	0.337	0.496	0.678	0.890	1.147	1.439	1.762	2.123	2.512	2.942
265	10.1/2"	0.116	0.158	0.217	0.269	0.343	0.505	0.691	0.907	1.169	1.466	1.796	2.163	2.560	2.997
270	10.5/8"	0.119	0.161	0.221	0.274	0.349	0.514	0.704	0.924	1.191	1.493	1.829	2.203	2.607	3.053
275	10.3/4"	0.121	0.164	0.225	0.279	0.356	0.524	0.717	0.941	1.212	1.520	1.862	2.243	2.654	3.108

MATERIALS

SEE TECHNICAL ENCLOSURE

COATINGS

SEE TECHNICAL ENCLOSURE

FULLY THREADED
STUDBOLTS
ANSI B16.5

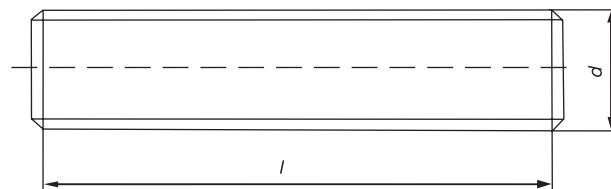

SALES DEPT.: TEL. ++39 02 96.97.98.20
PURCHASE DEPT.: TEL. ++39 02 96.97.98.30
EXPEDITING DEPT.: TEL. ++39 02 96.97.98.40

VIA DELL'ARTIGIANATO 12 - 22078 TURATE (CO) - ITALY
TEL. ++39 02 96.97.98.01 - FAX ++39 02 96.97.98.29
E-MAIL: info@pressbolt.com - WEB SITE: www.pressbolt.com

PRESS BOLT S.R.L.

d \ l		WEIGHT (Kg) PER 1 PIECE (IMPERIAL SIZE)														
		3/8"	7/16"	1/2"	9/16"	5/8"	3/4"	7/8"	1"	1.1/8"	1.1/4"	1.3/8"	1.1/2"	1.5/8"	1.3/4"	
280	11"	0.123	0.167	0.229	0.284	0.362	0.533	0.730	0.958	1.234	1.548	1.895	2.283	2.702	3.164	
285	11.1/4"	0.125	0.170	0.233	0.289	0.368	0.542	0.742	0.974	1.256	1.575	1.929	2.323	2.749	3.219	
290	11.1/2"	0.127	0.173	0.237	0.294	0.375	0.552	0.755	0.991	1.277	1.602	1.962	2.363	2.797	3.275	
295	11.5/8"	0.129	0.176	0.242	0.299	0.381	0.561	0.768	1.008	1.299	1.629	1.995	2.403	2.844	3.330	
300	11.3/4"	0.131	0.179	0.246	0.304	0.387	0.570	0.781	1.025	1.321	1.656	2.028	2.443	2.891	3.386	
305	12"	0.134	0.182	0.250	0.309	0.394	0.580	0.794	1.042	1.342	1.683	2.062	2.483	2.939	3.441	
310	12.1/4"	0.136	0.184	0.254	0.314	0.400	0.589	0.806	1.058	1.364	1.710	2.095	2.523	2.986	3.497	
315	12.1/2"	0.138	0.187	0.258	0.319	0.406	0.598	0.819	1.075	1.386	1.738	2.128	2.563	3.034	3.552	
320	12.5/8"	0.140	0.190	0.262	0.324	0.413	0.608	0.832	1.092	1.407	1.765	2.161	2.603	3.081	3.608	
325	12.3/4"	0.142	0.193	0.266	0.329	0.419	0.617	0.845	1.109	1.429	1.792	2.195	2.643	3.128	3.663	
330	13"	0.144	0.196	0.270	0.334	0.425	0.626	0.858	1.126	1.451	1.819	2.228	2.683	3.176	3.719	
335	13.1/4"	0.147	0.199	0.274	0.339	0.432	0.636	0.870	1.142	1.472	1.846	2.261	2.723	3.223	3.774	
340	13.3/8"	0.149	0.202	0.278	0.344	0.438	0.645	0.883	1.159	1.494	1.873	2.294	2.763	3.271	3.830	
345	13.1/2"	0.151	0.205	0.282	0.349	0.445	0.655	0.896	1.176	1.516	1.901	2.328	2.804	3.318	3.885	
350	13.3/4"	0.153	0.208	0.286	0.354	0.451	0.664	0.909	1.193	1.537	1.928	2.361	2.844	3.365	3.941	
355	14"	0.155	0.211	0.290	0.359	0.457	0.673	0.922	1.210	1.559	1.955	2.394	2.884	3.413	3.996	
360	14.1/4"	0.157	0.214	0.294	0.364	0.464	0.683	0.934	1.226	1.580	1.982	2.427	2.924	3.460	4.052	
365	14.3/8"	0.159	0.217	0.298	0.369	0.470	0.692	0.947	1.243	1.602	2.009	2.461	2.964	3.508	4.107	
370	14.1/2"	0.162	0.220	0.302	0.374	0.476	0.701	0.960	1.260	1.624	2.036	2.494	3.004	3.555	4.163	
375	14.3/4"	0.164	0.223	0.306	0.379	0.483	0.711	0.973	1.277	1.645	2.063	2.527	3.044	3.602	4.218	
380	15"	0.166	0.225	0.310	0.384	0.489	0.720	0.986	1.294	1.667	2.091	2.560	3.084	3.650	4.274	
385	15.1/4"	0.168	0.228	0.314	0.389	0.495	0.729	0.998	1.310	1.689	2.118	2.594	3.124	3.697	4.329	
390	15.3/8"	0.170	0.231	0.318	0.394	0.502	0.739	1.011	1.327	1.710	2.145	2.627	3.164	3.745	4.385	
395	15.1/2"	0.172	0.234	0.322	0.399	0.508	0.748	1.024	1.344	1.732	2.172	2.660	3.204	3.792	4.440	
400	15.3/4"	0.175	0.237	0.326	0.404	0.514	0.757	1.037	1.361	1.754	2.199	2.693	3.244	3.839	4.496	
405	16"	0.177	0.240	0.330	0.409	0.521	0.767	1.050	1.378	1.775	2.226	2.727	3.284	3.887	4.551	
410	16.1/4"	0.179	0.243	0.334	0.414	0.527	0.776	1.062	1.394	1.797	2.253	2.760	3.324	3.934	4.607	
415	16.3/8"	0.181	0.246	0.338	0.419	0.533	0.785	1.075	1.411	1.819	2.281	2.793	3.364	3.982	4.662	
420	16.1/2"	0.183	0.249	0.342	0.424	0.540	0.795	1.088	1.428	1.840	2.308	2.826	3.404	4.029	4.718	
425	16.3/4"	0.185	0.252	0.346	0.429	0.546	0.804	1.101	1.445	1.862	2.335	2.860	3.444	4.076	4.773	
430	17"	0.187	0.255	0.350	0.434	0.552	0.813	1.114	1.462	1.884	2.362	2.893	3.484	4.124	4.829	
435	17.1/8"	0.190	0.258	0.354	0.439	0.559	0.823	1.126	1.478	1.905	2.389	2.926	3.524	4.171	4.884	
440	17.1/4"	0.192	0.261	0.358	0.444	0.565	0.832	1.139	1.495	1.927	2.416	2.959	3.564	4.219	4.940	
445	17.1/2"	0.194	0.264	0.362	0.449	0.572	0.842	1.152	1.512	1.949	2.444	2.993	3.605	4.266	4.995	
450	17.3/4"	0.196	0.266	0.366	0.454	0.578	0.851	1.165	1.529	1.970	2.471	3.026	3.645	4.313	5.051	
455	18"	0.198	0.269	0.370	0.459	0.584	0.860	1.178	1.546	1.992	2.498	3.059	3.685	4.361	5.106	
460	18.1/8"	0.200	0.272	0.374	0.464	0.591	0.870	1.190	1.562	2.013	2.525	3.092	3.725	4.408	5.162	
465	18.1/4"	0.203	0.275	0.378	0.468	0.597	0.879	1.203	1.579	2.035	2.552	3.126	3.765	4.456	5.217	
470	18.1/2"	0.205	0.278	0.382	0.473	0.603	0.888	1.216	1.596	2.057	2.579	3.159	3.805	4.503	5.273	
475	18.3/4"	0.207	0.281	0.386	0.478	0.610	0.898	1.229	1.613	2.078	2.606	3.192	3.845	4.550	5.328	
480	18.7/8"	0.209	0.284	0.390	0.483	0.616	0.907	1.242	1.630	2.100	2.634	3.225	3.885	4.598	5.384	
485	19"	0.211	0.287	0.394	0.488	0.622	0.916	1.254	1.646	2.122	2.661	3.259	3.925	4.645	5.439	
490	19.1/4"	0.213	0.290	0.398	0.493	0.629	0.926	1.267	1.663	2.143	2.688	3.292	3.965	4.693	5.495	
495	19.1/2"	0.216	0.293	0.403	0.498	0.635	0.935	1.280	1.680	2.165	2.715	3.325	4.005	4.740	5.550	
500	19.3/4"	0.218	0.296	0.407	0.503	0.641	0.944	1.293	1.697	2.187	2.742	3.358	4.045	4.787	5.606	
MATERIALS		SEE TECHNICAL ENCLOSURE							COATINGS		SEE TECHNICAL ENCLOSURE					

FULLY THREADED STUDBOLTS ANSI B16.5

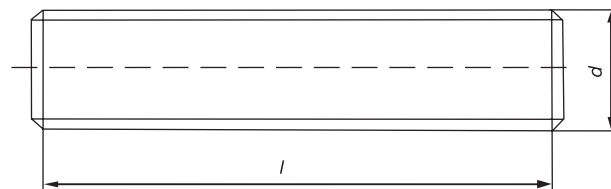

d \ l		WEIGHT (Kg) PER 1 PIECE (IMPERIAL SIZE)													
		1.7/8"	2"	2.1/4"	2.1/2"	2.3/4"	3"	3.1/4"	3.1/2"	3.3/4"	4"				
50	2"	0.704	0.803	1.029	1.282	1.557	1.865	2.228	2.596	2.915	3.348				
55	2.1/4"	0.768	0.876	1.122	1.398	1.698	2.034	2.430	2.832	3.180	3.653				
60	2.3/8"	0.832	0.949	1.216	1.515	1.840	2.204	2.633	3.068	3.445	3.957				
65	2.1/2"	0.896	1.022	1.309	1.631	1.981	2.373	2.835	3.304	3.710	4.262				
70	2.3/4"	0.960	1.095	1.403	1.748	2.123	2.543	3.038	3.540	3.975	4.566				
75	3"	1.024	1.168	1.496	1.864	2.264	2.712	3.240	3.776	4.240	4.870				
80	3.1/8"	1.088	1.241	1.590	1.981	2.406	2.882	3.443	4.012	4.505	5.175				
85	3.1/4"	1.152	1.314	1.683	2.097	2.547	3.051	3.645	4.248	4.770	5.479				
90	3.1/2"	1.216	1.387	1.777	2.214	2.689	3.221	3.848	4.484	5.035	5.784				
95	3.3/4"	1.280	1.460	1.870	2.330	2.830	3.390	4.050	4.720	5.300	6.088				
100	4"	1.344	1.533	1.964	2.447	2.972	3.560	4.253	4.956	5.565	6.392				
105	4.1/8"	1.408	1.606	2.057	2.563	3.113	3.729	4.455	5.192	5.830	6.697				
110	4.1/4"	1.472	1.679	2.151	2.680	3.255	3.899	4.658	5.428	6.095	7.001				
115	4.1/2"	1.536	1.752	2.244	2.796	3.396	4.068	4.860	5.664	6.360	7.306				
120	4.3/4"	1.600	1.825	2.338	2.913	3.538	4.238	5.063	5.900	6.625	7.610				
125	5"	1.664	1.898	2.431	3.029	3.679	4.407	5.265	6.136	6.890	7.914				
130	5.1/8"	1.728	1.971	2.525	3.146	3.821	4.577	5.468	6.372	7.155	8.219				
135	5.1/4"	1.792	2.044	2.618	3.262	3.962	4.746	5.670	6.608	7.420	8.523				
140	5.1/2"	1.856	2.117	2.712	3.379	4.104	4.916	5.873	6.844	7.685	8.828				
145	5.3/4"	1.920	2.190	2.805	3.495	4.245	5.085	6.075	7.080	7.950	9.132				
150	6"	1.984	2.263	2.899	3.612	4.387	5.255	6.278	7.316	8.215	9.436				
155	6.1/8"	2.048	2.336	2.992	3.728	4.528	5.424	6.480	7.552	8.480	9.741				
160	6.1/4"	2.112	2.409	3.086	3.845	4.670	5.594	6.683	7.788	8.745	10.045				
165	6.1/2"	2.176	2.482	3.179	3.961	4.811	5.763	6.885	8.024	9.010	10.350				
170	6.3/4"	2.240	2.555	3.273	4.078	4.953	5.933	7.088	8.260	9.275	10.654				
175	6.7/8"	2.304	2.628	3.366	4.194	5.094	6.102	7.290	8.496	9.540	10.958				
180	7"	2.368	2.701	3.460	4.311	5.236	6.272	7.493	8.732	9.805	11.263				
185	7.1/4"	2.432	2.774	3.553	4.427	5.377	6.441	7.695	8.968	10.070	11.567				
190	7.1/2"	2.496	2.847	3.647	4.544	5.519	6.611	7.898	9.204	10.335	11.872				
195	7.3/4"	2.560	2.920	3.740	4.660	5.660	6.780	8.100	9.440	10.600	12.176				
200	7.7/8"	2.624	2.993	3.834	4.777	5.802	6.950	8.303	9.676	10.865	12.480				
205	8"	2.688	3.066	3.927	4.893	5.943	7.119	8.505	9.912	11.130	12.785				
210	8.1/4"	2.752	3.139	4.021	5.010	6.085	7.289	8.708	10.148	11.395	13.089				
215	8.1/2"	2.816	3.212	4.114	5.126	6.226	7.458	8.910	10.384	11.660	13.394				
220	8.3/4"	2.880	3.285	4.208	5.243	6.368	7.628	9.113	10.620	11.925	13.698				
225	8.7/8"	2.944	3.358	4.301	5.359	6.509	7.797	9.315	10.856	12.190	14.002				
230	9"	3.008	3.431	4.395	5.476	6.651	7.967	9.518	11.092	12.455	14.307				
235	9.1/4"	3.072	3.504	4.488	5.592	6.792	8.136	9.720	11.328	12.720	14.611				
240	9.1/2"	3.136	3.577	4.582	5.709	6.934	8.306	9.923	11.564	12.985	14.916				
245	9.5/8"	3.200	3.650	4.675	5.825	7.075	8.475	10.125	11.800	13.250	15.220				
250	9.3/4"	3.264	3.723	4.769	5.942	7.217	8.645	10.328	12.036	13.515	15.524				
255	10"	3.328	3.796	4.862	6.058	7.358	8.814	10.530	12.272	13.780	15.829				
260	10.1/4"	3.392	3.869	4.956	6.175	7.500	8.984	10.733	12.508	14.045	16.133				
265	10.1/2"	3.456	3.942	5.049	6.291	7.641	9.153	10.935	12.744	14.310	16.438				
270	10.5/8"	3.520	4.015	5.143	6.408	7.783	9.323	11.138	12.980	14.575	16.742				
275	10.3/4"	3.584	4.088	5.236	6.524	7.924	9.492	11.340	13.216	14.840	17.046				

MATERIALS

SEE TECHNICAL ENCLOSURE

COATINGS

SEE TECHNICAL ENCLOSURE

SALES DEPT.: TEL. ++39 02 96.97.98.20
PURCHASE DEPT.: TEL. ++39 02 96.97.98.30
EXPEDITING DEPT.: TEL. ++39 02 96.97.98.40

VIA DELL'ARTIGIANATO 12 - 22078 TURATE (CO) - ITALY
TEL. ++39 02 96.97.98.01 - FAX ++39 02 96.97.98.29
E-MAIL: info@pressbolt.com - WEB SITE: www.pressbolt.com

PRESS BOLT
S.R.L.



FULLY THREADED
STUDBOLTS
ANSI B16.5

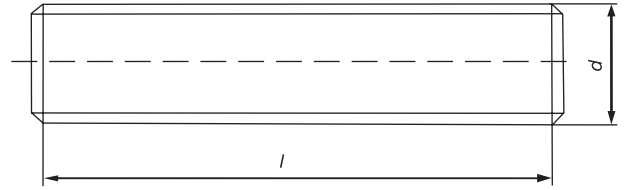

SALES DEPT.: TEL. ++39 02 96.97.98.20
PURCHASE DEPT.: TEL. ++39 02 96.97.98.30
EXPEDITING DEPT.: TEL. ++39 02 96.97.98.40

VIA DELL'ARTIGIANATO 12 - 22078 TURATE (CO) - ITALY
TEL. ++39 02 96.97.98.01 - FAX ++39 02 96.97.98.29
E-MAIL: info@pressbolt.com - WEB SITE: www.pressbolt.com

PRESS BOLT
S.R.L.

d \ l		WEIGHT (Kg) PER 1 PIECE (IMPERIAL SIZE)													
		1.7/8"	2"	2.1/4"	2.1/2"	2.3/4"	3"	3.1/4"	3.1/2"	3.3/4"	4"				
280	11"	3.648	4.161	5.330	6.641	8.066	9.662	11.543	13.452	15.105	17.351				
285	11.1/4"	3.712	4.234	5.423	6.757	8.207	9.831	11.745	13.688	15.370	17.655				
290	11.1/2"	3.776	4.307	5.517	6.874	8.349	10.001	11.948	13.924	15.635	17.960				
295	11.5/8"	3.840	4.380	5.610	6.990	8.490	10.170	12.150	14.160	15.900	18.264				
300	11.3/4"	3.904	4.453	5.704	7.107	8.632	10.340	12.353	14.396	16.165	18.568				
305	12"	3.968	4.526	5.797	7.223	8.773	10.509	12.555	14.632	16.430	18.873				
310	12.1/4"	4.032	4.599	5.891	7.340	8.915	10.679	12.758	14.868	16.695	19.177				
315	12.1/2"	4.096	4.672	5.984	7.456	9.056	10.848	12.960	15.104	16.960	19.482				
320	12.5/8"	4.160	4.745	6.078	7.573	9.198	11.018	13.163	15.340	17.225	19.786				
325	12.3/4"	4.224	4.818	6.171	7.689	9.339	11.187	13.365	15.576	17.490	20.090				
330	13"	4.288	4.891	6.265	7.806	9.481	11.357	13.568	15.812	17.755	20.395				
335	13.1/4"	4.352	4.964	6.358	7.922	9.622	11.526	13.770	16.048	18.020	20.699				
340	13.3/8"	4.416	5.037	6.452	8.039	9.764	11.696	13.973	16.284	18.285	21.004				
345	13.1/2"	4.480	5.110	6.545	8.155	9.905	11.865	14.175	16.520	18.550	21.308				
350	13.3/4"	4.544	5.183	6.639	8.272	10.047	12.035	14.378	16.756	18.815	21.612				
355	14"	4.608	5.256	6.732	8.388	10.188	12.204	14.580	16.992	19.080	21.917				
360	14.1/4"	4.672	5.329	6.826	8.505	10.330	12.374	14.783	17.228	19.345	22.221				
365	14.3/8"	4.736	5.402	6.919	8.621	10.471	12.543	14.985	17.464	19.610	22.526				
370	14.1/2"	4.800	5.475	7.013	8.738	10.613	12.713	15.188	17.700	19.875	22.830				
375	14.3/4"	4.864	5.548	7.106	8.854	10.754	12.882	15.390	17.936	20.140	23.134				
380	15"	4.928	5.621	7.200	8.971	10.896	13.052	15.593	18.172	20.405	23.439				
385	15.1/4"	4.992	5.694	7.293	9.087	11.037	13.221	15.795	18.408	20.670	23.743				
390	15.3/8"	5.056	5.767	7.387	9.204	11.179	13.391	15.998	18.644	20.935	24.048				
395	15.1/2"	5.120	5.840	7.480	9.320	11.320	13.560	16.200	18.880	21.200	24.352				
400	15.3/4"	5.184	5.913	7.574	9.437	11.462	13.730	16.403	19.116	21.465	24.656				
405	16"	5.248	5.986	7.667	9.553	11.603	13.899	16.605	19.352	21.730	24.961				
410	16.1/4"	5.312	6.059	7.761	9.670	11.745	14.069	16.808	19.588	21.995	25.265				
415	16.3/8"	5.376	6.132	7.854	9.786	11.886	14.238	17.010	19.824	22.260	25.570				
420	16.1/2"	5.440	6.205	7.948	9.903	12.028	14.408	17.213	20.060	22.525	25.874				
425	16.3/4"	5.504	6.278	8.041	10.019	12.169	14.577	17.415	20.296	22.790	26.178				
430	17"	5.568	6.351	8.135	10.136	12.311	14.747	17.618	20.532	23.055	26.483				
435	17.1/8"	5.632	6.424	8.228	10.252	12.452	14.916	17.820	20.768	23.320	26.787				
440	17.1/4"	5.696	6.497	8.322	10.369	12.594	15.086	18.023	21.004	23.585	27.092				
445	17.1/2"	5.760	6.570	8.415	10.485	12.735	15.255	18.225	21.240	23.850	27.396				
450	17.3/4"	5.824	6.643	8.509	10.602	12.877	15.425	18.428	21.476	24.115	27.700				
455	18"	5.888	6.716	8.602	10.718	13.018	15.594	18.630	21.712	24.380	28.005				
460	18.1/8"	5.952	6.789	8.696	10.835	13.160	15.764	18.833	21.948	24.645	28.309				
465	18.1/4"	6.016	6.862	8.789	10.951	13.301	15.933	19.035	22.184	24.910	28.614				
470	18.1/2"	6.080	6.935	8.883	11.068	13.443	16.103	19.238	22.420	25.175	28.918				
475	18.3/4"	6.144	7.008	8.976	11.184	13.584	16.272	19.440	22.656	25.440	29.222				
480	18.7/8"	6.208	7.081	9.070	11.301	13.726	16.442	19.643	22.892	25.705	29.527				
485	19"	6.272	7.154	9.163	11.417	13.867	16.611	19.845	23.128	25.970	29.831				
490	19.1/4"	6.336	7.227	9.257	11.534	14.009	16.781	20.048	23.364	26.235	30.136				
495	19.1/2"	6.400	7.300	9.350	11.650	14.150	16.950	20.250	23.600	26.500	30.440				
500	19.3/4"	6.464	7.373	9.444	11.767	14.292	17.120	20.453	23.836	26.765	30.744				
MATERIALS		SEE TECHNICAL ENCLOSURE					COATINGS		SEE TECHNICAL ENCLOSURE						